

# MFN 86 XSafe

## Modular Ice Machine 1950 kg

Item #:
Project:
Quantity:



### FEATURES

- Semi-hermetic compressor. Stainless steel auger and freezing cylinder (evaporator). Equipped with an electromechanical control board.
- Ice breaker made in specially strengthened alloy, allowing for greater extrusion pressure to deliver a dryer-quality of nugget ice (92% dry).
- Long-lasting stainless steel roller-bearings.
- Double protection - electronic rotation sensor and drive coupling - on gear motor and gear reducer.
- Low- water sensor protection on refrigeration and gear motor system. Ice level thermostat for machine shut down.
- Stainless steel side panels in scotch-brite finish, with rounded corners for enhanced ease of cleaning and aesthetics.
- Side panels are removable on all four sides to ease maintenance and after-sales service operations.
- PS plastic top cover. Reduced height to ease installation.

### CONDENSING SYSTEM

Air cooled  
Water cooled

### REFRIGERANT GAS

R452A

### VOLTAGE V/Hz/ph

400/50/3N

### RECOMMENDED BINS

Head	Bins		kg
MFN 86	●	<b>UBH2250</b>	1068
	●	<b>SIS1350</b>	613 + 73 + 73

#### LEGEND:

- ✓ : Perfect combination between ice maker and bin
- : Ice chute cut-out performed upon installation
- CBTxxxxxxxx : need additional bin top



MFN S 86  
Nugget Small 1 g  
Ø 13,5 x H 13 mm

### CERTIFICATIONS



### OPERATING REQUIREMENTS

	Minimum	Maximum
Air temperature	10	43
Water temperature	5	38
Water pressure	1 bar (14 psi)	5 bar (70 psi)
Electrical voltage	-10%	+10%

**IMPORTANT NOTICE:**  
Models and specifications are subject to change without notice.  
This spec sheet is meant for commercial purpose only.  
For technical documentation please refer to our service manuals.

Download our free **App Scotsman Ice**  
Apple store  
Google play  
Windows store



[www.scotsman-ice.it](http://www.scotsman-ice.it)  
[www.scotsman-ice.com](http://www.scotsman-ice.com)

Modular Ice Machine 1950 kg

# MFN 86 *XSafe*

## Modular Ice Machine 1950 kg

Item #:
Project:
Quantity:

Modular Ice Machine 1950 kg

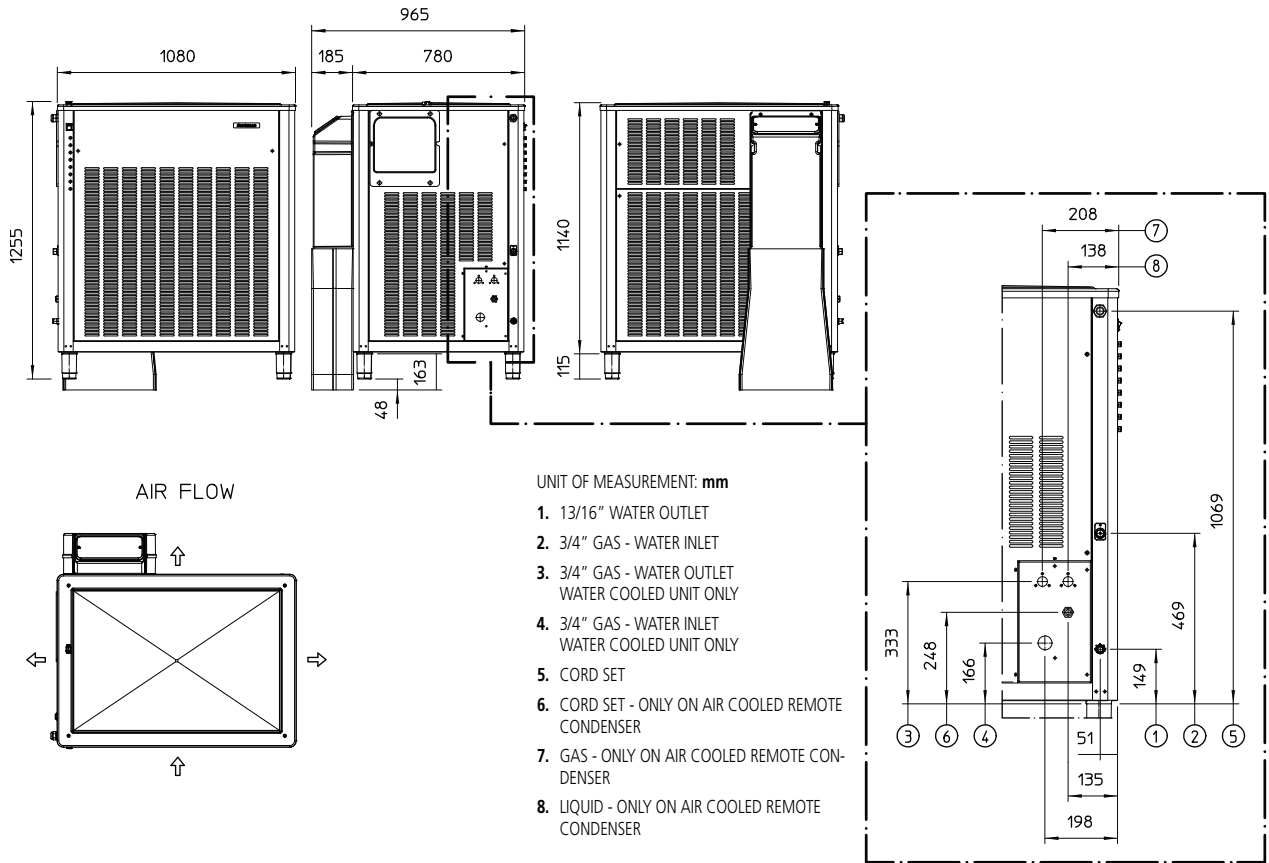

UNIT DATA		SHIPPING DATA									
Size (W x D x H)	1080 x 780 x 1255 mm	Carton (W x D x H)	1170 x 920 x 1340 mm								
Net weight	362 kg	Weight	383 kg								
Version	Voltage	24 h ice production kg °C Amb. / °C Water			Energy consumption (*)		Water usage (*)	Instant power	Compressor	Circuit wires	Max. fuse size
		10°C/10°C kg	21°C/10°C kg	32°C/21°C kg	kWh/ 100 kg	kWh/ 24h	l/h	W	W	No. x Ømm <sup>2</sup>	A
MFN S86 AS	400/50/3N	1900	1850	1500	9.6	149.0	64.6	6400	10000	5 x 4.0	25
MFN S86 WS	400/50/3N	1950	1810	1550	8	124	480	6400	10000	5 x 4.0	25

(\*) Data refer to 32°C Amb. / 21°C Water temperature conditions